

Where are the controls?

The display panel is located in a door compartment on the front of the heat pump. This compartment is designed to protect the display against harsh weather. It can also be padlocked for extra security.

- Press the **bottom** of the panel to open the display panel door.
- To close, push the display panel up. Then press the **bottom** of the panel until a clicking noise is heard.

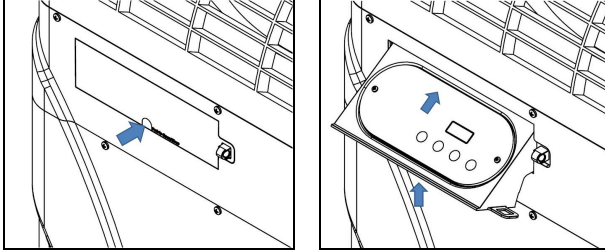

Is the heat pump getting power?

Activate power at external fuse box or the breaker box.

- The heat pump performs a lamp test.
- The display reads **888**.
- The heat pump then displays as normal.

Wake up heat pump

To wake up the control panel, tap a button on the display until it illuminates. Then slowly slide a finger across the buttons.

- The code **UnL** will briefly appear. Then either **FLO** or the water temperature will display.
- See manual for more information on waking up the heat pump.



What's on the display

Buttons	Description
Display Lock	Sliding your finger across the buttons from left to right will temporarily disable the display lock.
Pool / Spa	Select either the pool or the spa thermostat.
Up Arrow	Used to increase temperature set point and navigate through menu options.
Down Arrow	Used to decrease temperature set point and navigate through menu options.
Mode	Select heat pump's operating mode.

Display	Description
75	The heat pump is on and displaying the current water temperature. In this example 75° F is displayed.
FLO	No water flow is detected. The filter pump is off or heat pump is not receiving correct water flow.
OFF	The heat pump has been turned off via the mode selector button or the temperature set point has been lowered below 45° F.
888	The control program is initializing. This displays only as power is applied to the heat pump.

Indicators	Description
Pool	The Heat Pump is referencing the pool thermostat.
Spa	The Heat Pump is referencing the spa thermostat.
Heating	Indicates the unit is heating the water. Please note - the compressor must be operating before this light will illuminate.
Cooling	Indicates the unit is cooling the water. Please note - the compressor must be operating before this light will illuminate.
Water Temp	Indicates current water temperature.
Desired Temp	Indicates temperature set point is displayed. This is displayed when "UP" or "DOWN" is selected.

Choose what you want the heat pump to do



Heat the water

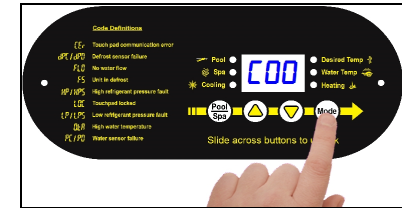

Cool the water



Keep a constant temperature



Turn off Heat Pump

Heating / Cooling modes only available on select equipment. Confirm heat pump features before setting a mode.

Set a desired temperature for the water



Select "POOL" or "SPA"



Press "UP" or "DOWN" to the desired temperature.

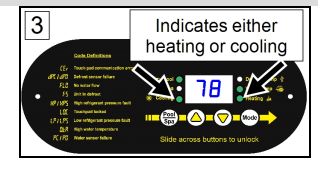

Indicates either heating or cooling

Heating the water for the first time?

1. Confirm heat pump mode has been set to heating mode.
2. Set thermostat to desired water temperature.
3. Temporarily set the filter pump for continuous operation.
4. Use a pool cover or blanket to reduce heating time.

Cooling the water for the first time?

1. Confirm heat pump mode has been set to cooling mode.
2. Set thermostat to desired water temperature.
3. Temporarily set the filter pump for continuous operation.
 - This will allow the Heat Pump the time required to cool the water at start-up.
 - After the water has reached the desired temperature, reset the filter pump to normal operating time-frames.

Pool Blankets

A pool blanket can assist the heater to maintain water temperature while significantly reducing heating costs. Conventional blankets, commonly referred to as "Solar Blankets", consist of a thin plastic-like membrane that floats on the water surface. To be effective solar blankets are physically placed over the water surface when the pool is not in use.



WARNING

- Failure to heed the following may result in injury or death.

- Improperly used, Pool-Spa solar blankets can become a drowning risk to people and pets. Solar blankets are not safety covers. They are not designed to support the weight of a person or pet. Never enter a pool until the solar cover is completely removed. Under no circumstances should anyone swim under the blanket. Follow all safety recommendations of the blanket manufacturer.

Pools typically lose 50% of the heat placed in the pool by the heater and / or sunlight.

- Blanketed pools will typically lose only 3° - 4° F of heat per night.
- This is compared to a typical heat loss of 8° - 10° F for a non-blanketed pool.

Liquid Blankets

For those who want to save on heating costs, but do not want the bother and potential dangers of a conventional blanket, a liquid blanket can be a viable alternative. A liquid-blanketed pool on average loses only 30% of its heat gain overnight. However, strong winds can reduce the effectiveness of liquid blankets. Check your pool dealer / supplier for more information on pool blankets and liquid blankets.

Water under the heat pump?

Water may be seen around the heat pump. This is normal condensation produced as a byproduct of this type of system. The amount of condensation depends on the amount of humidity in the air. Quantities of 8 to 10 gallons per hour are common. Low humidity may result in no condensation.

What can my heat pump do?

1. Find Data Plate - The data plate is usually posted on the side of the equipment or the inside of the heat pump's access plate.
2. Find the model number on the data plate. The first letters and numbers indicate the model type.
3. The complete model number identifies the equipment's features.

Model Number Example

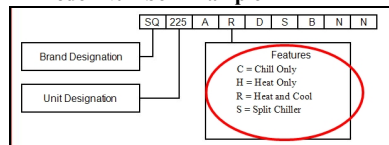

How can I find out more about my heat pump?

Please go online at www.AquaCal.com for installation, maintenance, winterization, equipment or troubleshooting advice.

For further assistance, please contact the distributor or installer of this product.

If unavailable, please contact AquaCal® for a partner in your area. To better assist you, please have the heat pump model and serial number available.

Product Information:

Website	www.AquaCal.com
Phone	(1) 727-823-5642
Hours	8-5 pm, Eastern M-F

Service Information:

Website	www.AquaCal.com/request-heat-pump-service/
---------	--